

Chaplin Road

Wembley • Middlesex • HA0 4UD

PCM: £1,100 PCM



coopers
est 1986

Coopers are DELIGHTED to present to the market this BRAND NEW studio, situated in a HIGHLY SOUGHT AFTER location within WALKING DISTANCE to several local High Street shops and a variety of TRANSPORT LINKS. Boasting an IMMACULATE FINISH throughout, this carefully designed EXECUTIVE apartment briefly comprises: generously proportioned lounge/bedroom with tiled flooring, wardrobes and a stunning en-suite.

Included in rent: COUNCIL TAX, WATER, GAS, ELECTRIC and INTERNET

Excludes: TV LICENSE

** Single occupants only however a couple will be considered however rent will vary**

** Parking available upon on request

BRAND NEW

Close to Wembley Park Station

Walking distance to local amenities

Communal kitchen

Ground Floor

ALL BILLS INCLUDED*

Tiled bathroom

Gated residence

Furnished

Available in October

Available Date

31st October 2025

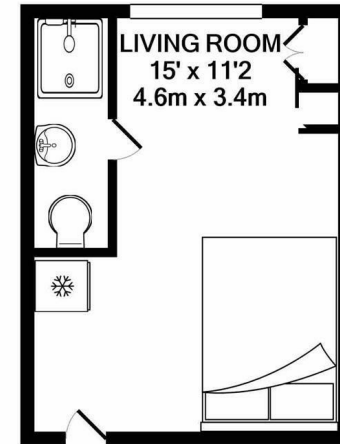

TOTAL APPROX. FLOOR AREA 167 SQ.FT. (15.5 SQ.M.)

Whilst every attempt has been made to ensure the accuracy of the floor plan contained here, measurements of doors, windows, rooms and any other items are approximate and no responsibility is taken for any error, omission, or mis-statement. This plan is for illustrative purposes only and should be used as such by any prospective purchaser. The services, systems and appliances shown have not been tested and no guarantee as to their operability or efficiency can be given

Made with Metropix ©2020



coopers
est 1986

0208 017 6000

18 Bridge Street, Pinner,
Middlesex, HA5 3JF

pinner@coopersresidential.co.uk

CoopersResidential.co.uk

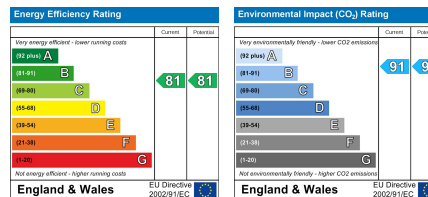

Important Notice: These particulars, whilst believed to be accurate are set out as a general outline only for guidance and do not constitute any part of an offer or contract. Intending purchasers should not rely on them as statements or representation of fact, but must satisfy themselves by inspection or otherwise has the authority to make or give any representation or warranty in respect of the property.